

CHARMILL

RESIDENTIAL



Abbey Road, St Johns Wood, NW8

A recently refurbished two-bedroom one bathroom apartment arranged on the ground floor of a purpose-built block on the famous Abbey Road. The apartment is located next door to Abbey Road Studios and the zebra crossing featured on the cover of the Beatles' album. The apartment comprises of two double bedrooms, reception room & dining rooms with wooden flooring, separate fully fitted kitchen and a new bathroom suite. Abbey House benefits from a porter daily from 9am -5pm.

- Two bedrooms
- One bathroom
- Ground floor
- Porter
- Unfurnished

£693

Ground Floor

Approx. 80.8 sq. metres (869.7 sq. feet)

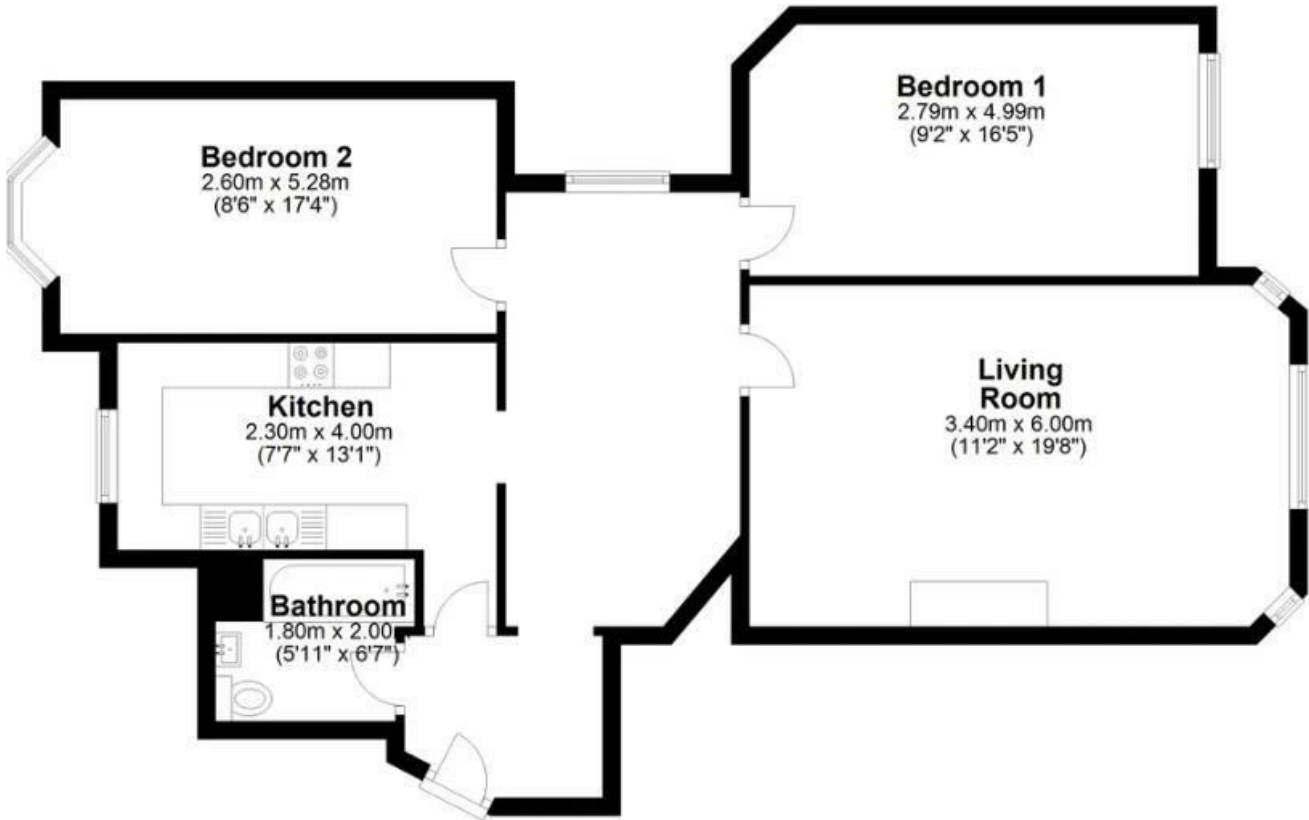

Total area: approx. 80.8 sq. metres (869.7 sq. feet)

Floor Plan measurements are approximate and are for illustrative purposes only.
Plan produced using PlanUp.

Energy Efficiency Rating		Current	Potential
Very energy efficient - lower running costs			
(92 plus) A			
(81-91) B			
(69-80) C			
(55-68) D			
(39-54) E			
(21-38) F			
(1-20) G			
Not energy efficient - higher running costs			
England & Wales		46	74
EU Directive 2002/91/EC			

Environmental Impact (CO ₂) Rating		Current	Potential
Very environmentally friendly - lower CO ₂ emissions			
(92 plus) A			
(81-91) B			
(69-80) C			
(55-68) D			
(39-54) E			
(21-38) F			
(1-20) G			
Not environmentally friendly - higher CO ₂ emissions			
England & Wales			
EU Directive 2002/91/EC			

